



ANALOGUE INSTRUMENTS

Analogue Instruments

SHUNTS

High value current connection on direct current circuits.

- Accuracy: 0,5% Operating t.: -20..+60 °C
- Overloads: 1.2 In continuously
- 10 In 5 s (10..500 A)
- 5 In 5 s (600..2000 A)
- 2 In 5 s (2500..4000 A)

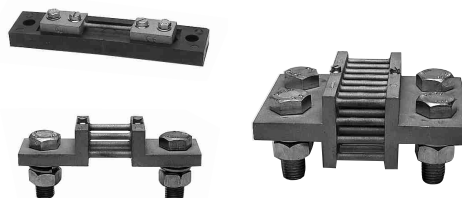

DIN 43703 standard							
Model		Form 1		Form 2		Form 3	
Voltage drop	mV	60 mV	150 mV	60 mV	150 mV	60 mV	150 mV
MEASURING RANGE	In	1; 1,5; 2,5; 4; 5; 6; 10; 15; 20; 25; 30; 40; 50; 60; 80; 100 or 150		200; 250; 300; 400; 500; 600; 750; 800; 1000; 1200; 1500; 2000 or 2500		200; 250; 300; 400; 500; 600; 750; 800 or 1000	
		3000 or 4000		1200; 1500; 2000 or 2500			

Approximate weight (Kg)																		
In	1	1,5	2,5	4	5	6	10	15	20	25	30	40	50	60	80	100	150	200
60 mV	0,140	0,140	0,140	0,140	0,140	0,140	0,140	0,140	0,140	0,140	0,120	0,120	0,125	0,125	0,125	0,125	0,130	0,535
150 mV	0,140	0,140	0,140	0,140	0,140	0,140	0,140	0,140	0,140	0,140	0,160	0,170	0,175	0,180	0,190	0,210	0,240	0,750
In	250	300	400	500	600	750	800	1000	1200	1500	2000	2500	3000	4000	-	-	-	-
60 mV	0,540	0,815	0,820	0,830	0,840	1,420	1,420	1,440	1,970	1,990	2,870	2,990	4,220	4,300	-	-	-	-
150 mV	0,790	1,130	1,200	1,250	1,310	2,350	2,390	2,510	3,670	3,860	5,220	5,530	-	-	-	-	-	-

Voltage drop mV	Rated current A	Exec. according to figure	a1	a2	b1	b2	b3	c1	c2	e	h	Current splice				Voltage splice
												No. of screws	Hexagonal screw DIN 933-5-8	Washer DIN 125-Sc	Nut DIN 934-5	
60	1; 1,5; 2,5; 4; 5*; 6; 10; 15; 20*; 25	1	90	28	20	-	-	8	-	78	-	2 x 1	M.5x12	5,3	-	2 M.5x8 cylinder-head screw DIN 84-4.8 and 2 ø 5.3 washers DIN 433-St.
	30*; 40; 50; 60; 80*; 100; 150	1	100	33	20	-	-	8	-	80	-	2 x 1	M.8x16	8,4	-	
	200*; 250	2	145	55	30	15	-	10	10	105	30	2 x 1	M.12x40	13	M.12	
	300*; 400; 500*; 600				40	20	-	10	10	105	30	2 x 2	M.16x45	17	M.16	
	750*; 800*; 1000	2	165	65	60	30	-	10	10	115	30	2 x 1	M.20x50	21	M.20	
	1200*; 1500				90	21	48	10	10	115	30	2 x 2	M.16x45	17	M.16	
2000*; 2500	2	165	65	120	30	60	10	10	115	30	2 x 2	M.20x50	21	M.20		
3000*; 4000	3	165	65	120	30	60	15	10	115	60	2 x 2	M.20x60	21	M.20		
150	1; 1,5; 2,5; 4; 5*; 6; 10; 15; 20*; 25	1	90	28	20	-	-	8	-	78	-	2 x 1	M.5x12	5,3	-	
	30*; 40; 50; 60; 80*; 100; 150	1	225	33	25	-	-	8	-	205	-	2 x 1	M.8x16	8,4	-	
	200*; 250	2	270	55	30	15	-	10	10	230	50	2 x 1	M.12x40	13	M.12	
	300*; 400; 500*; 600				40	20	-	10	10	230	50		M.16x45	17	M.16	
	750*; 800*	2	275	85	42,5	-	-	10	10	240	50	2 x 1	M.20x60	21	M.20	
	1000*				21	43	10	10	240	60	2 x 2	M.16x45	17	M.16		
1200*; 1500	3	290	65	90	21	48	15	10	240	60	2 x 2	M.16x60	17	M.16		
2000*; 2500	3	290	65	120	30	60	15	10	240	60	2 x 2	M.20x60	21	M.20		

* Non-DIN ranges, but of standard production.

